

## 1. Overview

### 1.1 Main Functions

- GPS + LBS + WIFI positioning
- Intelligent power saving
- IPX5 waterproof grade
- Tamper alert
- Strong magnet installation
- Fast charging
- 10000mAh battery
- Listen-in

### 1.2 Specifications

Frequency	GSM 850/900/1800/1900MHz
Location accuracy	<10 meters
Monitoring range	≤5 meters
Working voltage/ current	3.7V/ 60mA
Battery	10000mAh/3.7V industrial grade lithium polymer battery
Working hour	30 days (drive for 2 hours a day)
LED	Red: work status
Operating temperature	-20℃— +70℃
Dimension	108(L) x 61(W) x 30(H) mm
Weight	285g

## 2. Appearance

### 2.1 Appearance

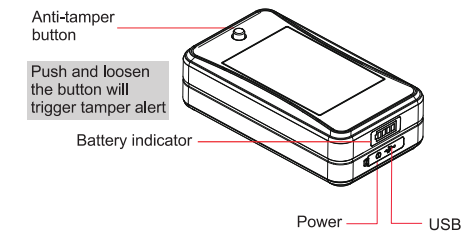
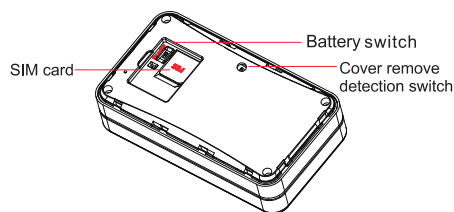
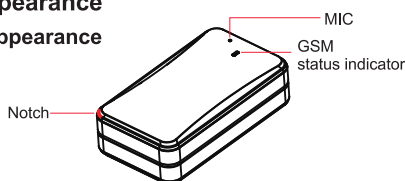

### 2.2 Standard Accessories

Device	1
Bracket	1
User guide	1
Charger	1
Charge cable	1

## 2.3 GSM Indicator

Status	Meaning
Flicker quickly ( every 0.3 seconds)	GSM initialization/ No GSM signal/ No SIM card
Flicker slowly ( 0.1s on; 2s off)	Login platform
Always ON	Calling

GSM indicator is off after the device power on for 3 minutes. If device power on, shortly press the power button to activate LED, which will be off in 60 seconds.

## 3. SIM card

SIM card should have access to GPRS and SMS. Remove the cover, switch to OFF and insert the SIM card.

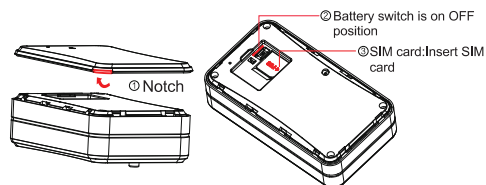

## 4. Installation

With strong magnet, the device has easy installation and can absorb on any magnetic item. Attached 3M foam tape and bracket help fix the device on non-magnetic items.

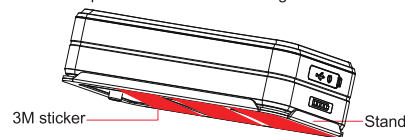

## 5. Operation

### 5.1 Power ON/OFF

Power on: Press power button for 3 seconds ( battery switch is in ON position)  
Power off: Press power button for 3 seconds

### 5.2 SOS Number

Set SOS number via APP, GPS tracking platform or SMS (SMS only valid in tracking mode)

- 1.SMS command to add SOS number:  
**SOS,A, number 1, number 2, number 3#**  
E.g. SOS,A,1351234xxxx, 1371234xxxx,1301234xxxx#
- 2.SMS command to delete SOS number:  
**SOS,D,number sequence 1, number sequence 2, number sequence 3#**  
E.g. SOS,D,1,2,3#
- 3.Query current SOS number:**SOS#**

### 5.3 Working Mode

(1)Tracking mode (default): GSM is always ON and location data uploaded in set time interval. Time interval can be set on APP or designated platform.

SMS command format:

**MODE,1,T1,T2#**

1 means tracking mode

T1: upload interval of GPS data in moving status, unit: second, 10-3600s; default: 10s  
T2:upload interval of GPS data in static status unit: second, 180-65535s; default: 3600s

(2) Ultra-long standby mode: device wakes up and uploads location data in a fixed time.

**Notice:** In this mode, all command will NOT be executed until the device wakes up at preset time interval. If you want to

compel the device to wake up and receive command, you can a. By trigger the tamper alert button at the back; b. By unplug the battery and plug it in again.

SMS command format:  
**MODE,2,T1,T2#**

"2" means ultra-standby mode.

"T1" means the start time of sleeping period. Format:

HH:MM.

"T2" means the sleep time interval, which options are 1,2,3,4,6,8,12,24,48,72 (hours).

Default: 24 hours.

Note: SMS command takes effect after device wakes up.

E.g.MODE,2,12:00.8# (Meaning: Device starts to fall asleep at 12:00, and wakes up every 8 hours)

### 5.4 Tamper Alert

The anti-tamper button will pop out and alert will be sent if the device is disassembled.

In standby mode, alert message will be uploaded and tracking mode will be activated for 20 minutes if device dis-assembly is detected. After 20 minutes, device enters into ultra-long standby mode. Dis-assembly alert can be turned off by command: **cancel#**

### 5.5 Cover Remove Alert

Cover detection button pops out and alert will be sent when device cover is dismantled.

In standby mode, alert message will be uploaded and tracking mode will be activated for 20 minutes if cover dismantlement is detected. After 20 minutes, device enters into ultra-long standby mode. Dis-assembly alert can be turned off by command: **cancel#**

### 5.6 Low Battery Alert

When battery is low, the device will activate low battery alarm.

## 5.7 Vibration alarm

The vibration alarm only works in mode 1 (tracking mode). To activate this function, please send **111** first to the SOS number and the device will be in arming status. To turn on the vibration alarm, please send command **SENALM, ON#**

SMS command for device disarming: **000**

## 5.8 Geo-fence alarm

The geo-fence alarm only works in mode 1 (tracking mode). When the vehicle enter/exit the preset geo-fence area, the device will send alarm to the SOS numbers when the geo-fence function is ON.

## 5.9 Voice monitoring

Use preset SOS number to send command **MONITOR#** to the device. Device would automatically call you back in a second. Pick up and monitor the voice inside the vehicle.

## 5.10 Power on alarm

Alarm will be sent when the device starts. SMS command:

**BOOTALM,A,M#**

A=ON/OFF; default: ON

M=0~3; alarming way, 0: GPRS, 1: SMS+GPRS; default: 0;

**BOOTALM,OFF#**

Turn off the power on alarm.

## 5.11 Power off alarm

Alarm will be sent when the device power off. SMS command:

**PWROFFALM,X,M#**

X=ON/OFF; default: ON

M=0~1; alarming way, 0: GPRS, 1: SMS+GPRS; default: 0;

## 5.12 Power off restriction

When power off restriction command is sent by SOS numbers,

the device can't power off by pressing the power button.

**PWRLIMIT,X#**

X=ON/OFF; ON: means power off forbidden, OFF: means allow to power off;

**PWRLIMIT#**

Check ON/OFF status.

## 6. Platform & APP

### 6.1 Login service platform

Please login the designated service platform to set and operate the device.

### 6.2 Download APP

Please download and install the APP in designated website, APP store or Google Play store.

## 7. Warning

Battery specified by manufacturer is recommended.

Maintenance or service arising from any other accessories is not guaranteed.

Manufacturer assumes no responsibility for any damage caused by non-original accessories.

Do not bend or open the battery.

Do not immerse or burn the battery.

Device dis-assembly is strongly forbidden.

Nonprofessionals' operation may cause device damage.

## Troubleshooting

If you are having trouble with your device, try these troubleshooting procedures before contacting a service professional.

Problems	Causes	Solutions
Poor signal	The signal waves are unable to transmit when use the GPS tracker in the places that have poor signal reception, such as: tall building around or basement.	Using the GPS tracker in the places that have good signal condition.
Unable to boot	Power switch is off	Switch to ON
	No battery	charge
	No SIM card	Insert SIM card
Unable to connect to the network	SIM card inserted incorrectly	Check SIM card
	Dirty things exist above the SIM card	Clean SIM card
	Invalid SIM card	Contact network supplier
	Not in GSM service area	Move to service area
Fail to locate	Poor signal	Move to area with strong signal
	SIM has no access to GPRS	Contact network supplier to get GPRS service
	Always reply "Address inquiry failed"	Contact supplier

## Warranty instructions and service

1.The warranty is valid only when the warranty card is properly completed, and upon presentation of the proof of purchase consisting of original invoice indicating the date of purchase, model and serial No.of the product. We reserve the right to refuse warranty if this information has been removed or changed after the original purchase of the product from the dealer.

2. Our obligations are limited to repair of the defect or replacement the defective part or at its discretion replacement of the product itself.

3. Warranty repairs must be carried out by our Authorized Service Centre. Warranty cover will be void, even if a repair has been attempted by any unauthorized service centre.

4. Repair or replacement under the terms of this warranty does not provide right to extension or renewal of the warranty period.

5. The warranty is not applicable to cases other than defects in material, design and workmanship.

## Maintenance Record

Date	Serviced by
Product Model	
IMEI Number	
Fault Descriptions	
Comments	

# Asset GPS Tracker

## User Guide

(Version 1.4)

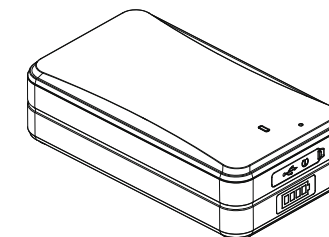

To ensure quickly and correctly use, please read this manual carefully before using. Any changes to the product appearance, color or accessories are without notice.